

# QBF-818-918-45

## 0.818~0.918GHz, 45dB

**Features:**

- \* High Stopband Rejection
- \* Small Size

**Applications:**

- \* Telecom
- \* Laboratory Test
- \* Receivers
- \* Instrumentation

**Electrical**

Frequency:	0.818~0.918GHz
-1dB Passband Width:	100MHz min.
Passband Insertion Loss:	3dB max.
Stopband Attenuation:	45dB@668MHz min. 45dB@1068MHz min.
VSWR:	1.5 max.

**Mechanical**

Size <sup>*1</sup> :	35*12*8mm 1.378*0.472*0.315in
RF Connectors:	SMA female
Mounting:	4-M2 depth 5mm

[1] Exclude connectors.

**Environmental**

Operating Temperature:	-40~+70°C
Non-operating Temperature:	-55~+85°C

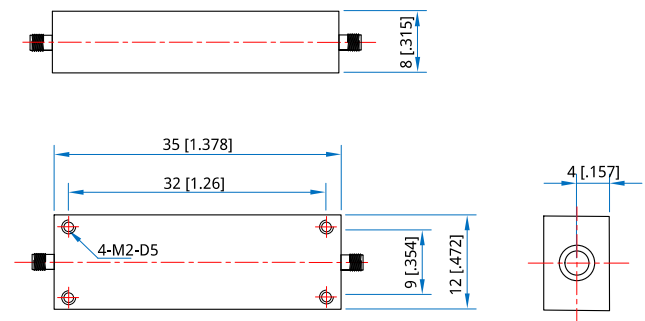
**Outline Drawings**

Unit: mm [in]

Tolerance:  $\pm 0.2$ mm [ $\pm 0.008$ in]

**How To Order**

**QBF-818-918-45**

Customization is available upon request.